



TIS 40 NUT ROASTING MACHINE

Range of Product:	TIS
Product or component type:	Nut Roaster
Short name:	TIS 40
Sale per indivisible quantity:	1
Conformity:	MD 2006/42/EC, LVD 2006/95/EC EN 291-1:1991, EN 292-2:1995, EN 294:1992, EN 6020-1:1997, EN 1050:1996
Order Number:	TIS 40
Product Weight:	1100 kg
Product Weight Net:	900 kg
Ambient Temperature:	+4°C / ~ /+40°C

Batch Capacity:	40 Kg	
Roasting Time: (Ürüne ve ürünün nem oranına göre)	15 Minutes For Sesame 50 Minutes For Barley	
Source of Heat:	LPG-Natural Gas Or Diesel	
Heating Type:	Thermal Transfer Or Hotair	
Dimensions (LxWxH):	85x160x210 cm	
Suggested Using Area (LxWxH):	250x250x300 cm	
Voltage:	110 ~ 415 Volt, 50-60 hz, 1-3 Phase	
Electric Consumption:	220 Volt / 50Hz / Single Phase	380 Volt / 50Hz / Three Phase
	3,7 KW / 20 AMPERE	3,7 KW / 8,7 AMPERE
Quantity of Motor:	2	
Color:	Black, Red, Green, Chrome or Customer Preference	
Temp. Control :	Digital Temperature control	
Drum Material:	304 Stainless Steel	
Polluted Air Stream:	42 ppm CO	
	% 16.9 O2	
	% 2,6 CO2	
Combustion:	LPG	NATURAL GAS
	33.300 Kcal / 131.900 BTU / 38.65 kWh	43.200 Kcal / 171.400 BTU / 50.23 kWh
Gas Connection Point:	1/2"	
Necessary Air Volume	350 m³/h	
Exhaust Pipe Size	150 mm	
Revision No/Date	P08-DK-05-01 / 29.07.2016	



You can choose your color from RAL color codes

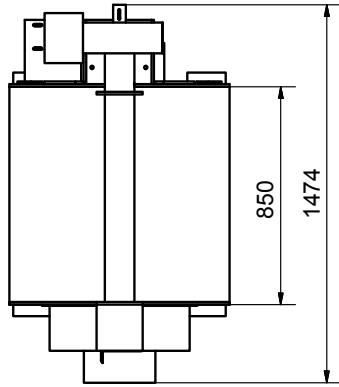
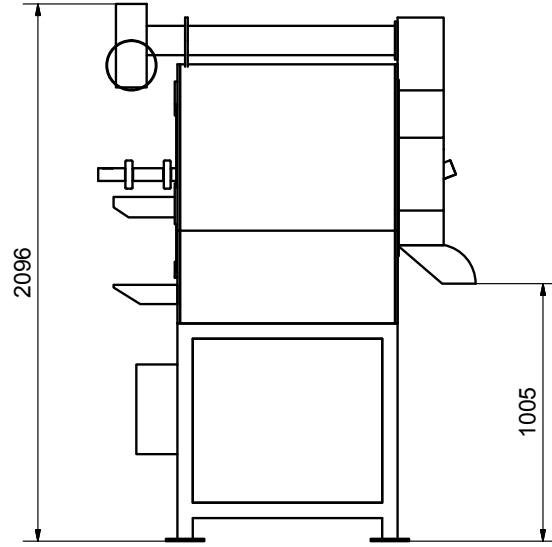
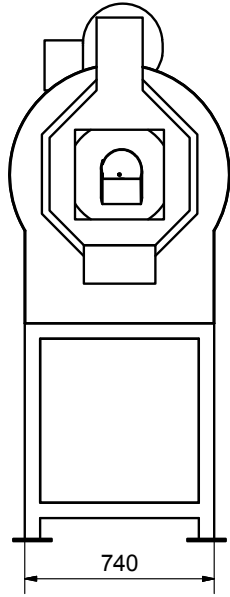

TIS 40

